















# FARNHAM ESTATE

SPA & GOLF RESORT

-  Twin Socket Outlet
-  Floorbox
-  Audio Visual Facilities Panel
-  Data point
-  Lighting Controller
-  Plasma TV
-  Electric projection screen drops from the ceiling
-  15" TFT Flat screen monitor for display of individual conference room detail
-  Recessed Ceiling mounted A/V Speaker Outlet
-  Recessed Ceiling mounted A/V Speaker Outlet (KEF Speaker)
-  LP820 Projector & Scissors Lift
-  Microphone Aerial mounted at high level in ceiling

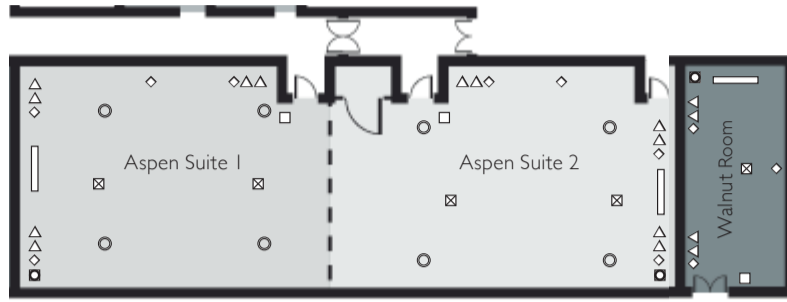

## WOODLANDS SUITES

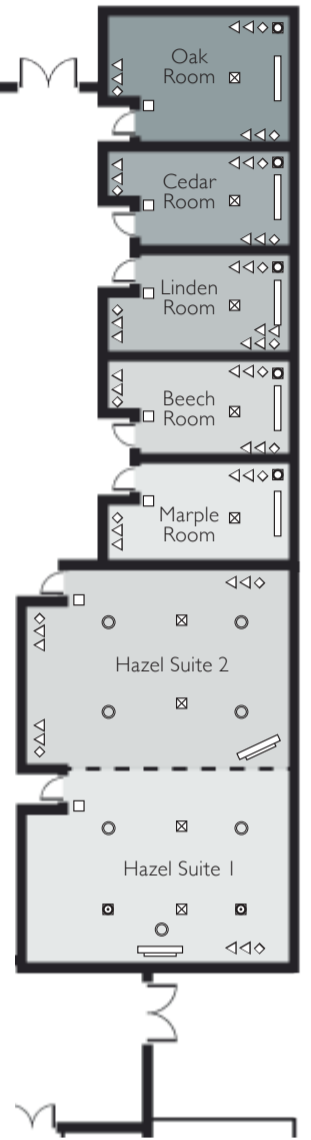

## REDWOOD SUITE

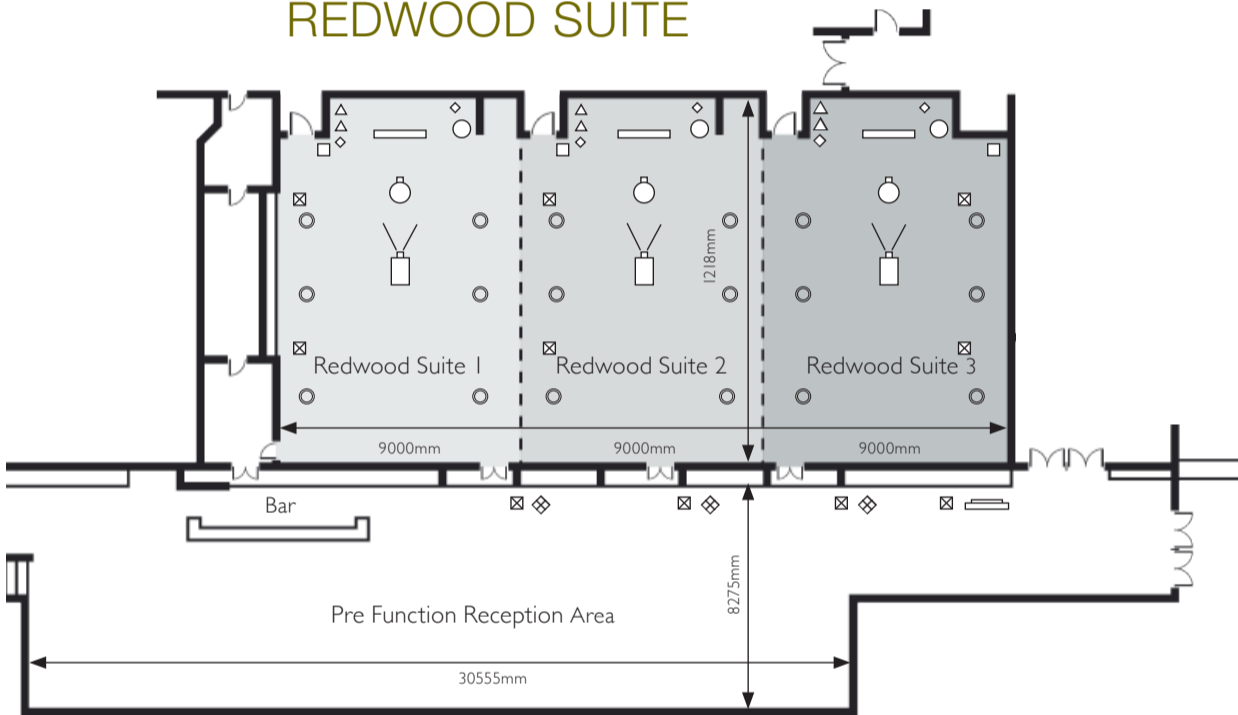

	FLOOR AREA M <sup>2</sup>	CEILING HEIGHT	BANQUET	BOARDROOM	CABERET	CLASSROOM	THEATRE STYLE	U-SHAPE	DAYLIGHT
<b>The Redwood Suite</b>	346	5	220	-	176	200	380	-	No
Redwood Suite 1	116	5	60	-	56	70	126	32	No
Redwood Suite 2	114	5	80	-	56	70	126	32	No
Redwood Suite 3	116	5	80	-	56	70	126	32	No
<b>The Hazel Suite</b>	84	3	40	28	28	30	64	26	Yes
Hazel Suite 1	43	3	20	14	12	15	32	13	Yes
Hazel Suite 2	41	3	20	14	12	15	32	13	Yes
The Maple Room	13	3	-	8	-	-	-	-	Yes
The Beach Room	13	3	-	8	-	-	-	-	Yes
The Linden Room	13	3	-	8	-	-	-	-	Yes
The Cedar Room	13	3	-	8	-	-	-	-	Yes
The Oak Room	18	3	-	8	-	-	-	-	Yes
The Walnut Room	17	3	-	10	-	-	-	-	Yes
<b>The Aspen Suite</b>	112	3	60	44	36	58	100	44	Yes
Aspen Suite 1	54	3	30	22	18	24	40	22	Yes
Aspen Suite 2	58	3	30	22	18	24	44	22	Yes

## CAPACITY CHART