



# FARNHAM ESTATE

SPA & GOLF RESORT



## FARNHAM ESTATE VITAL STATISTICS

- 158 spacious guest rooms including 12 luxurious suites
- Self contained conference centre including a 346 sqm fully equipped ballroom and 10 meeting rooms with natural daylight
- 40,000 sq foot Health Spa with an Indoor/Outdoor Infinity Pool, Watermint Thermal Suite, Gymnasium, Relaxation Rooms and 19 Treatment Rooms
- 18 hole championship designed Golf Course
- 7 km of walking & biking trails through ancient woodlands
- FREE high-speed wireless internet through the entire hotel

### DISTANCES FROM FARNHAM ESTATE

TO BELFAST	150 KM
TO SLIGO	100 KM
TO GALWAY	160 KM
TO DUBLIN	120 KM
TO CORK	240 KM

TO BOOK CALL +353 49 437 7700, EMAIL [INFO@FARNHAMESTATE.IE](mailto:INFO@FARNHAMESTATE.IE)  
OR VISIT [WWW.FARNHAMESTATE.COM](http://WWW.FARNHAMESTATE.COM)



# FARNHAM ESTATE

SPA & GOLF RESORT



## WOODLANDS SUITES

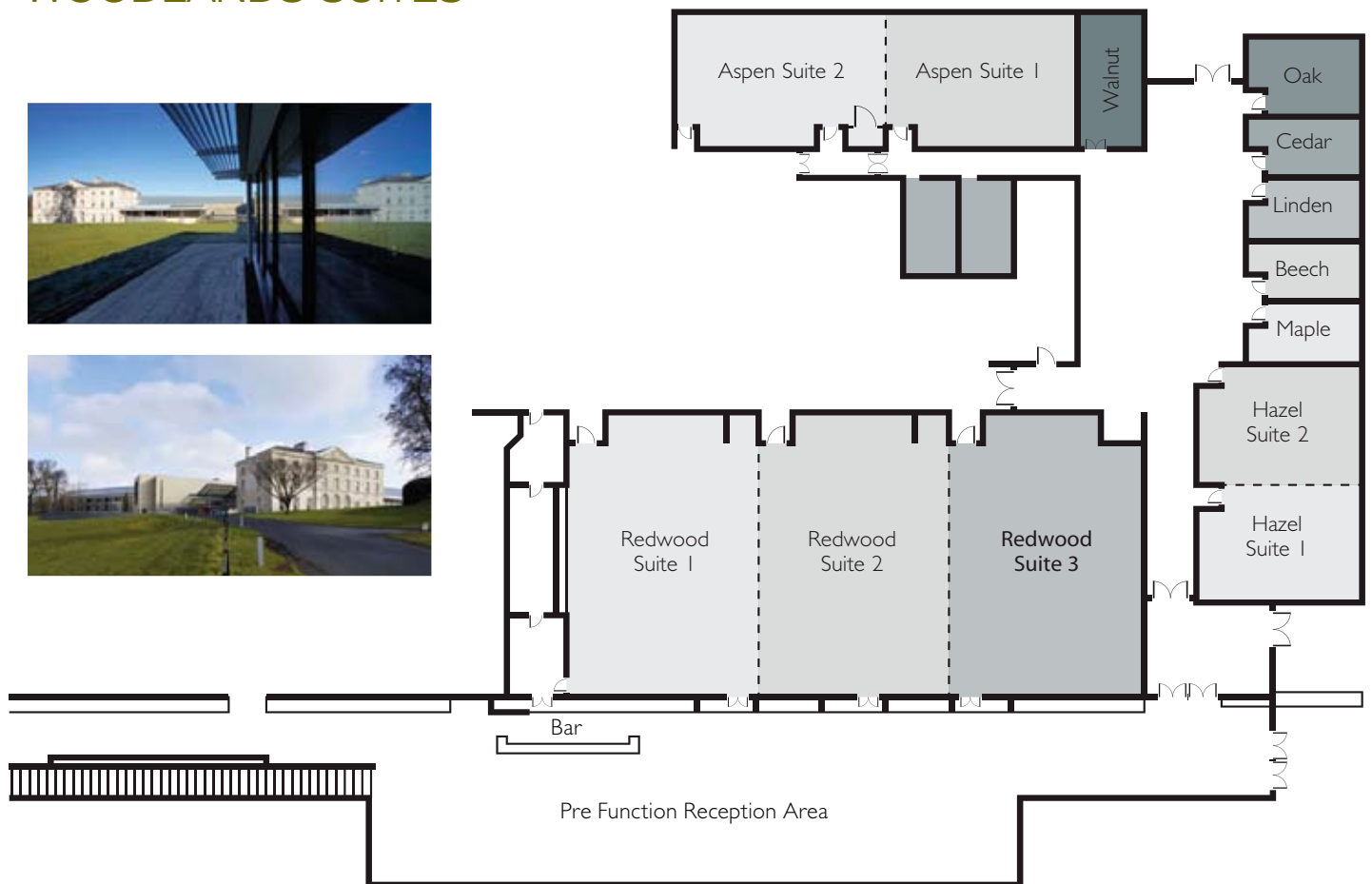

TO BOOK CALL +353 49 437 7700, EMAIL [INFO@FARNHAMESTATE.IE](mailto:INFO@FARNHAMESTATE.IE)  
OR VISIT [WWW.FARNHAMESTATE.COM](http://WWW.FARNHAMESTATE.COM)



# FARNHAM ESTATE

SPA & GOLF RESORT



## WOODLANDS SUITES

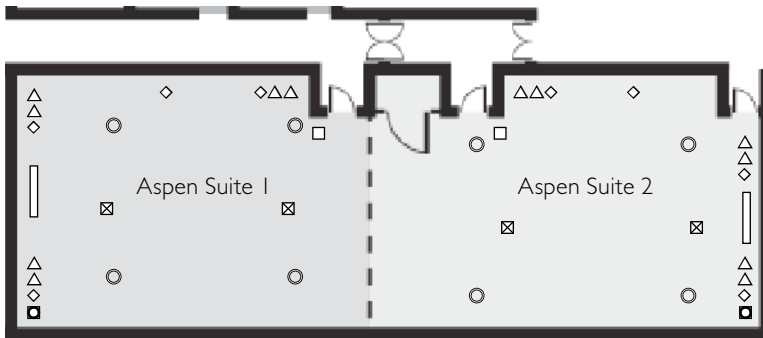

- ⌘ Twin Socket Outlet
- ⊠ Floorbox
- ⌚ Audio Visual Facilities Panel
- Ⓢ Data point
- Lighting Controller
- ▭ Electric projection screen drops from the ceiling
- ∇ 15" TFT Flat screen monitor for display of individual conference room detail
- ◼ Recessed Ceiling mounted A/V Speaker Outlet
- ◼ Recessed Ceiling mounted A/V Speaker Outlet (KEF Speaker)
- ⌚ Plasma TV
- ∇ LP820 Projector & Scissors Lift
- Microphone Aerial mounted at high level in ceiling

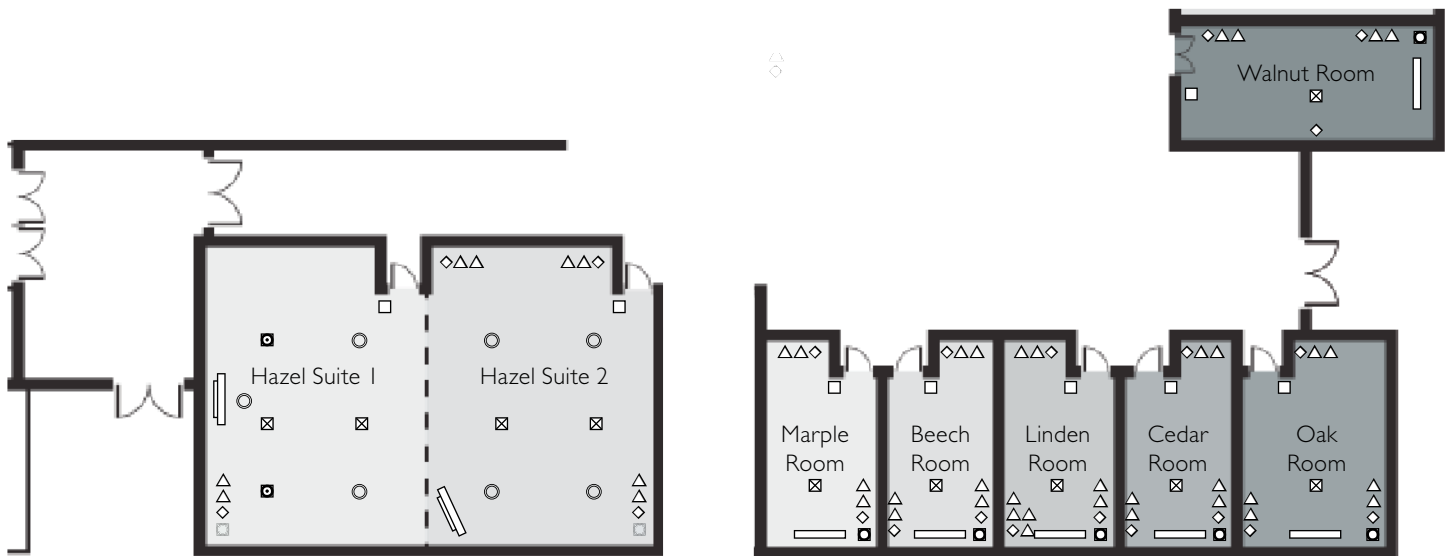

TO BOOK CALL +353 49 437 7700, EMAIL [INFO@FARNHAMESTATE.IE](mailto:INFO@FARNHAMESTATE.IE)  
OR VISIT [WWW.FARNHAMESTATE.COM](http://WWW.FARNHAMESTATE.COM)



# FARNHAM ESTATE

SPA & GOLF RESORT



## REDWOOD SUITE

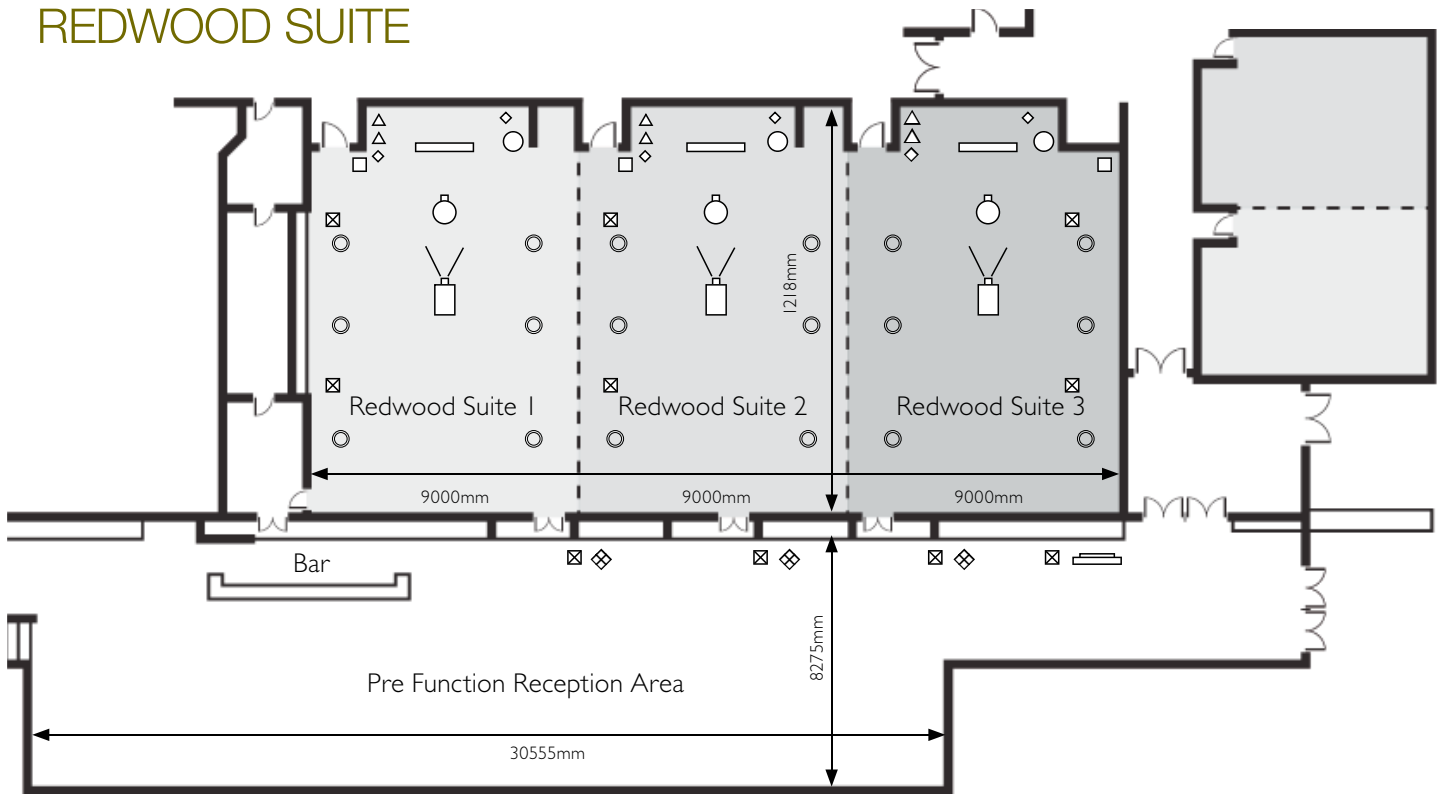

- |   |  |
|---|--|
| <ul style="list-style-type: none"> <li>⏏ Twin Socket Outlet</li> <li>⊠ Floorbox</li> <li>⏏ Audio Visual Facilities Panel</li> <li>⊙ Data point</li> <li>□ Lighting Controller</li> <li>⏏ Plasma TV</li> </ul> | <ul style="list-style-type: none"> <li>⏏ Electric projection screen drops from the ceiling</li> <li>⏏ 15" TFT Flat screen monitor for display of individual conference room detail</li> <li>⏏ Recessed Ceiling mounted A/V Speaker Outlet</li> <li>⏏ Recessed Ceiling mounted A/V Speaker Outlet (KEF Speaker)</li> <li>⏏ LP820 Projector &amp; Scissors Lift</li> <li>⊙ Microphone Aerial mounted at high level in ceiling</li> </ul> |
|---|--|

TO BOOK CALL +353 49 437 7700, EMAIL [INFO@FARNHAMESTATE.IE](mailto:INFO@FARNHAMESTATE.IE)  
OR VISIT [WWW.FARNHAMESTATE.COM](http://WWW.FARNHAMESTATE.COM)



# FARNHAM ESTATE

## SPA & GOLF RESORT



## CAPACITY CHART

	Floor area m <sup>2</sup>	Ceiling height	Banquet	Boardroom	Theatre style	U-Shape	Classroom	Daylight
The Redwood Suite	346	5	220	-	380	-	200	No
Redwood Suite 1	116	5	60	-	126	32	70	No
Redwood Suite 2	114	5	80	-	126	32	70	No
Redwood Suite 3	116	5	80	-	126	32	70	No
The Hazel Suite	84	3	40	28	64	26	30	Yes
Hazel Suite 1	43	3	20	14	32	13	15	Yes
Hazel Suite 2	41	3	20	14	32	13	15	Yes
The Maple Room	13	3	-	8	-	-	-	Yes
The Beach Room	13	3	-	8	-	-	-	Yes
The Linden Room	13	3	-	8	-	-	-	Yes
The Cedar Room	13	3	-	8	-	-	-	Yes
The Oak Room	18	3	-	8	-	-	-	Yes
The Walnut Room	17	3	-	10	-	-	-	Yes
The Aspen Suite	112	3	60	44	100	44	58	Yes
Aspen Suite 1	54	3	30	22	40	22	24	Yes
Aspen Suite 2	58	3	30	22	44	22	24	Yes

TO BOOK CALL +353 49 437 7700, EMAIL [INFO@FARNHAMSTATE.IE](mailto:INFO@FARNHAMSTATE.IE)  
OR VISIT [WWW.FARNHAMSTATE.COM](http://WWW.FARNHAMSTATE.COM)